

18-NOV-2014 D:\DN\_Files\Standard\Drawings\Imp\etal\2012\Approved\Issues\Suppl\0\Approved\SN2A.dgn

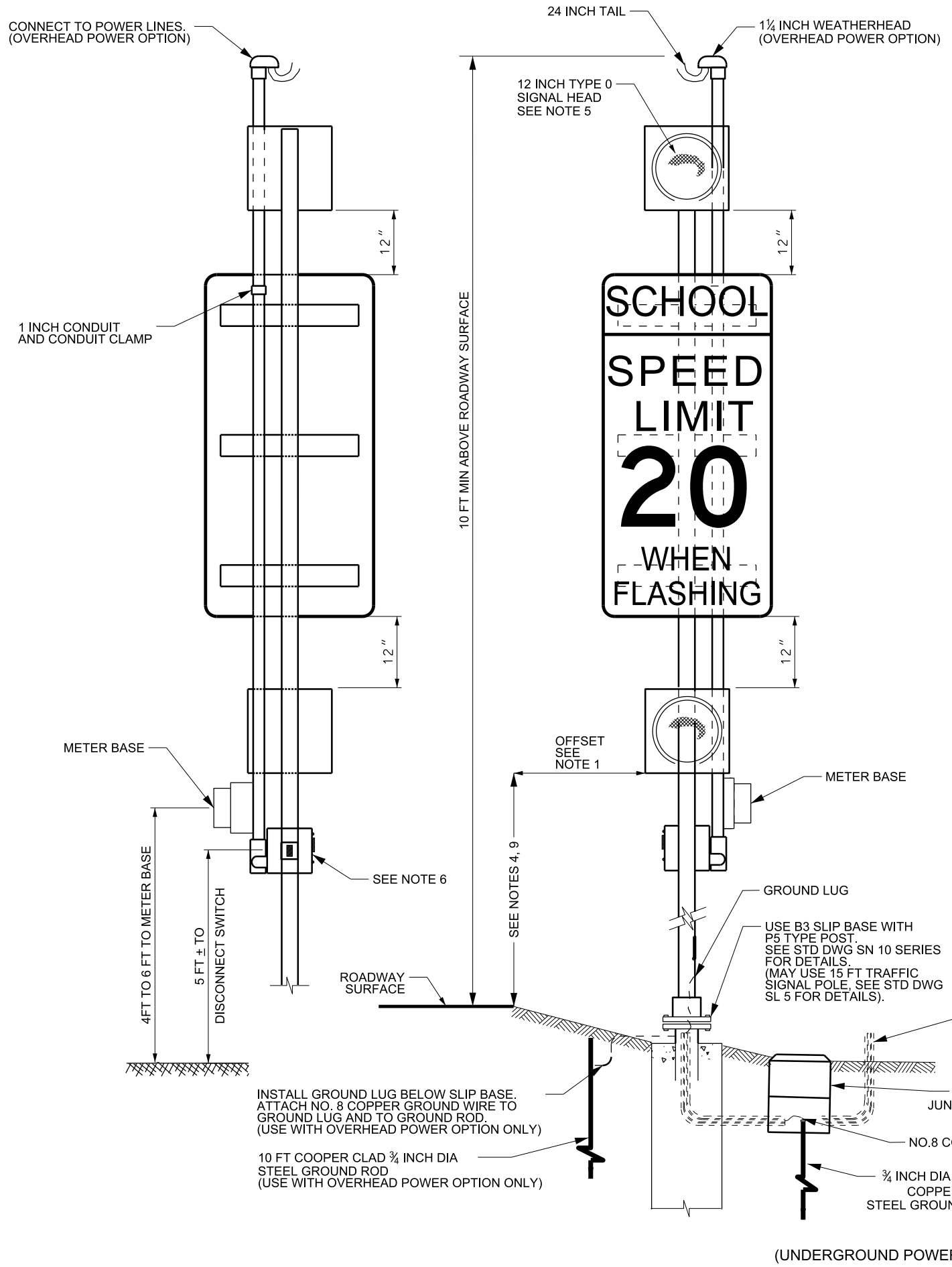

UTILITY POWER OPTION

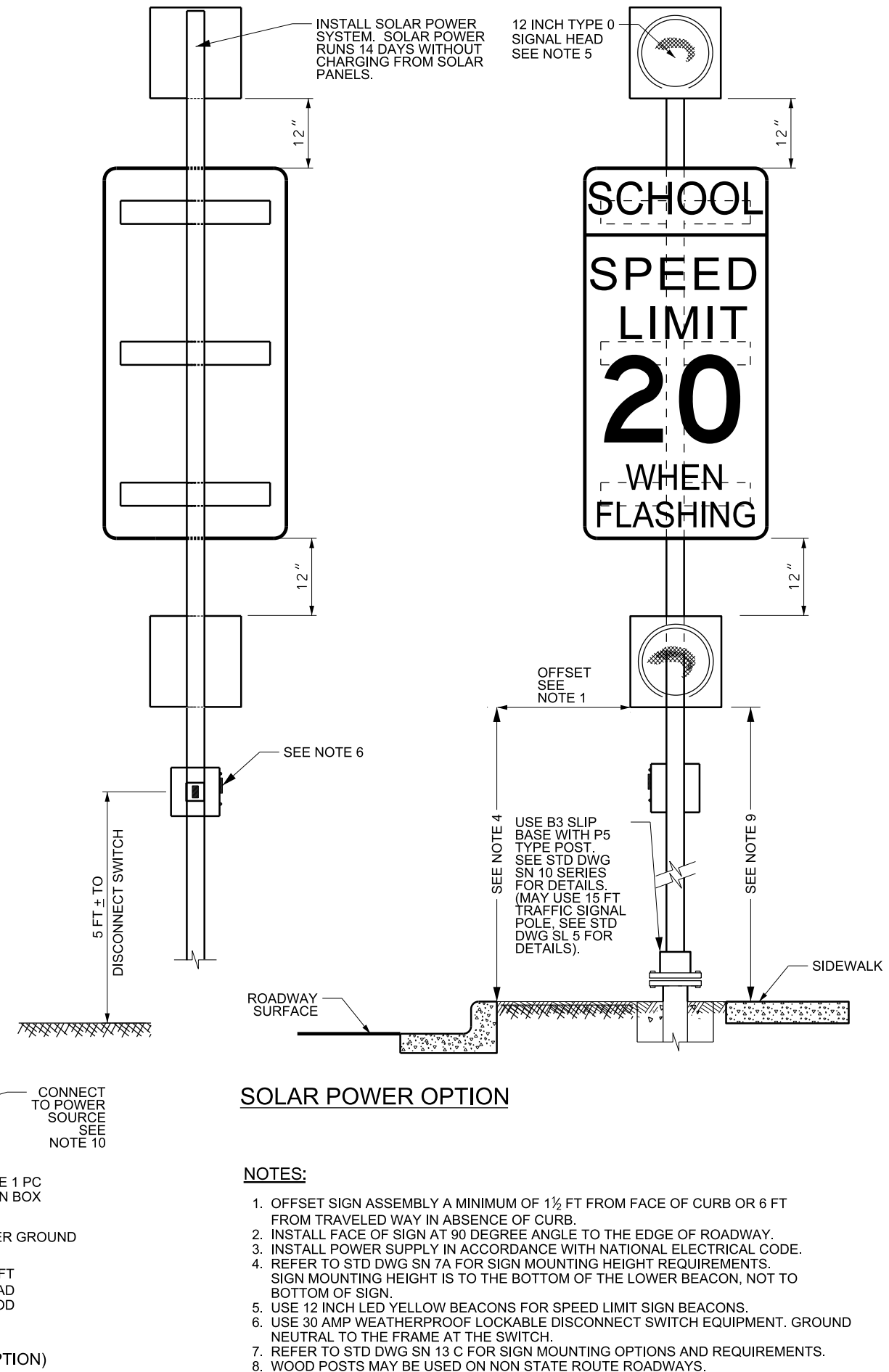

SOLAR POWER OPTION

- NOTES:**
1. OFFSET SIGN ASSEMBLY A MINIMUM OF 1 1/2 FT FROM FACE OF CURB OR 6 FT FROM TRAVELED WAY IN ABSENCE OF CURB.
  2. INSTALL FACE OF SIGN AT 90 DEGREE ANGLE TO THE EDGE OF ROADWAY.
  3. INSTALL POWER SUPPLY IN ACCORDANCE WITH NATIONAL ELECTRICAL CODE.
  4. REFER TO STD DWG SN 7A FOR SIGN MOUNTING HEIGHT REQUIREMENTS. SIGN MOUNTING HEIGHT IS TO THE BOTTOM OF THE LOWER BEACON, NOT TO BOTTOM OF SIGN.
  5. USE 12 INCH LED YELLOW BEACONS FOR SPEED LIMIT SIGN BEACONS.
  6. USE 30 AMP WEATHERPROOF LOCKABLE DISCONNECT SWITCH EQUIPMENT. GROUND NEUTRAL TO THE FRAME AT THE SWITCH.
  7. REFER TO STD DWG SN 13 C FOR SIGN MOUNTING OPTIONS AND REQUIREMENTS.
  8. WOOD POSTS MAY BE USED ON NON STATE ROUTE ROADWAYS.
  9. PROVIDE A 7 FT MIN MOUNTING HEIGHT FOR ALL SIGNS OR BEACONS WHEN THEY ENCR OACH 4 INCHES OR MORE LATERALLY ABOVE A PEDESTRIAN WALK WAY.
  10. CONNECT TO POWER SOURCE. SEE STD DWG SL SERIES.

SUPPLEMENTAL DRAWING

REVISIONS		NO.	DATE	APPR.	REMARKS
1	10/31/2013	LJM			MOVE FLASHER ASSEMBLIES TO TOP & BOTTOM OF SIGN. DELETED OPTION FOR 8 INCH BEACONS IN NOTE 5. ADDED NEW NOTES 9 AND 10. ADDED UNDERGROUND POWER OPTION.
2	11/06/2014	JLL			MODIFIED VERTICAL SPACE SIGN AND BEACONS TO 12 INCHES IN CONFORMANCE WITH MUTCD. MODIFIED NOTE 4 AND THE LOCATION OF METER BASE. ADDED OPTION FOR TRAFFIC SIGNAL POLE. REMOVED SOLID STATE FLASHER ASSEMBLY.

UTAH DEPARTMENT OF TRANSPORTATION  
STANDARD DRAWINGS FOR ROAD AND BRIDGE CONSTRUCTION  
SALT LAKE CITY, UTAH

RECOMMENDED FOR APPROVAL  
*Randy A. Park*  
CHAIRMAN STANDARDS COMMITTEE

NOV.06.2014  
DATE

NOV.06.2014  
DATE

DEPUTY DIRECTOR

SCHOOL SPEED LIMIT ASSEMBLY

STANDARD DRAWING TITLE

STD. DWG. NO.  
SN 2A