

DGN File: 0:\Standard\Specs\Section\2017\Section\011_Supp_Issues\Issue_4_02-22-2018\Drawings\SL06G.dgn 07-MAR-2018

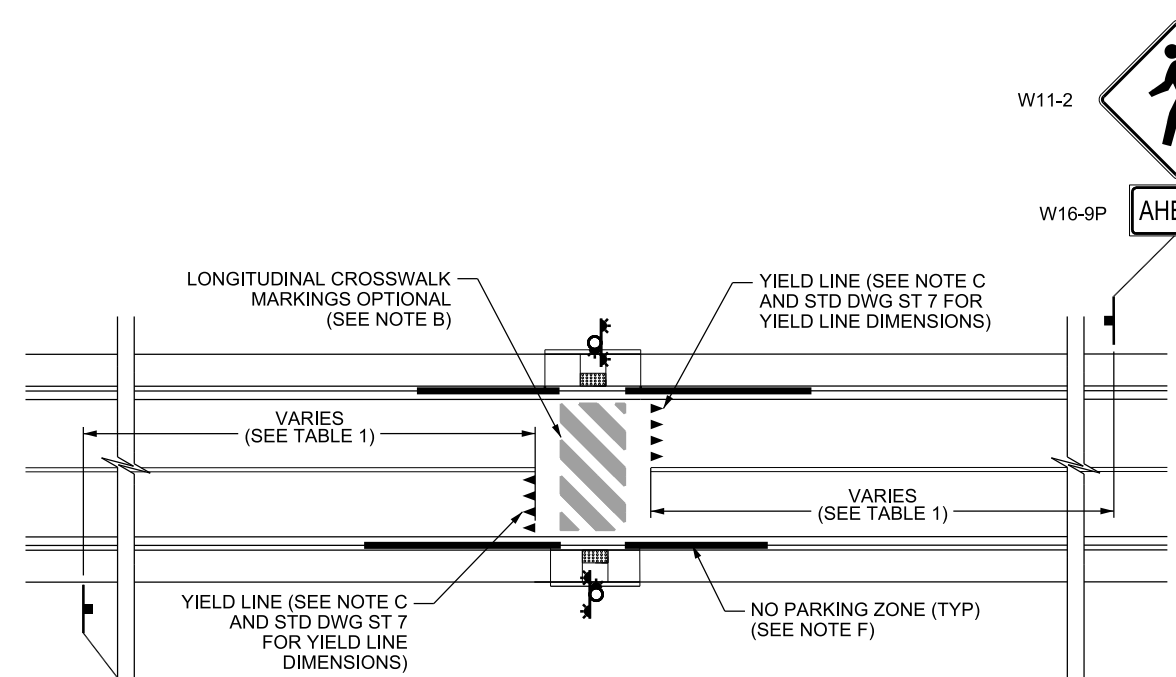

SINGLE-LANE DETAIL

TABLE 1
GUIDELINES FOR ADVANCE PLACEMENT OF
PEDESTRIAN CROSSING WARNING SIGNS
(SEE UTAH MUTCD TABLE 2C-4 FOR COMPLETE TABLE)

POSTED SPEED	ADVANCE PLACEMENT DISTANCE
20-35 MPH	100 FT
40 MPH (SEE NOTE E)	125 FT

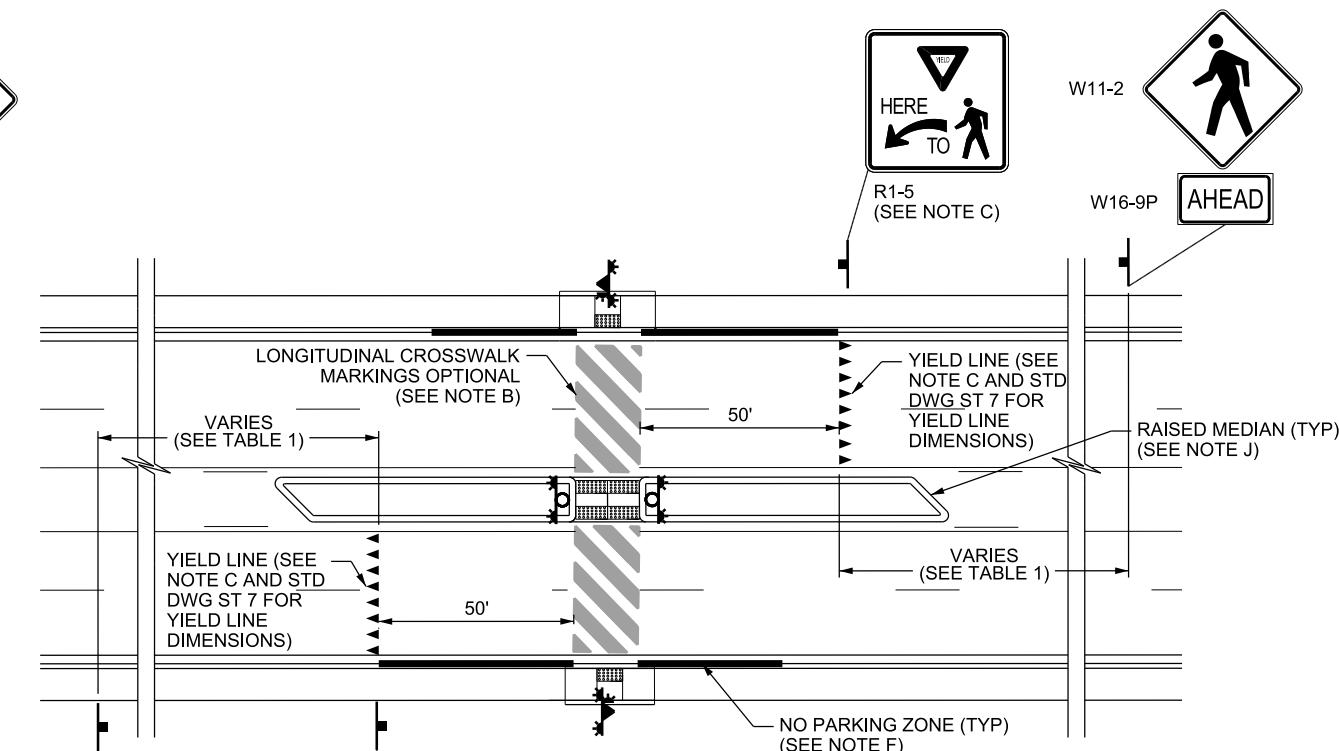
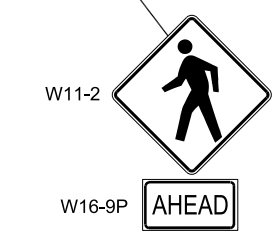

MULTI-LANE DETAIL

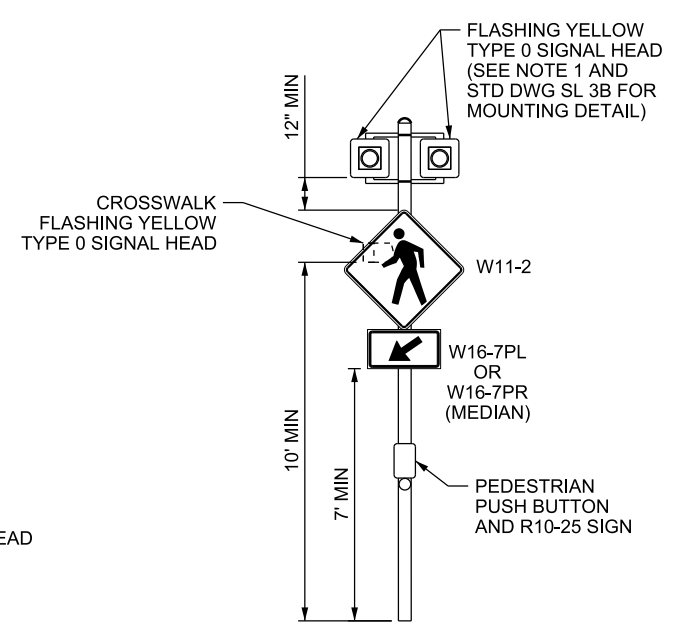
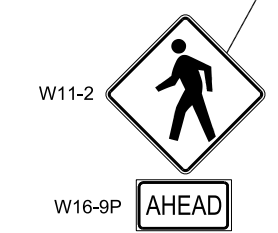

FLASHING BEACON DETAIL

15 FT TRAFFIC SIGNAL POLE (SEE NOTE I AND STD DWG SL 1E)

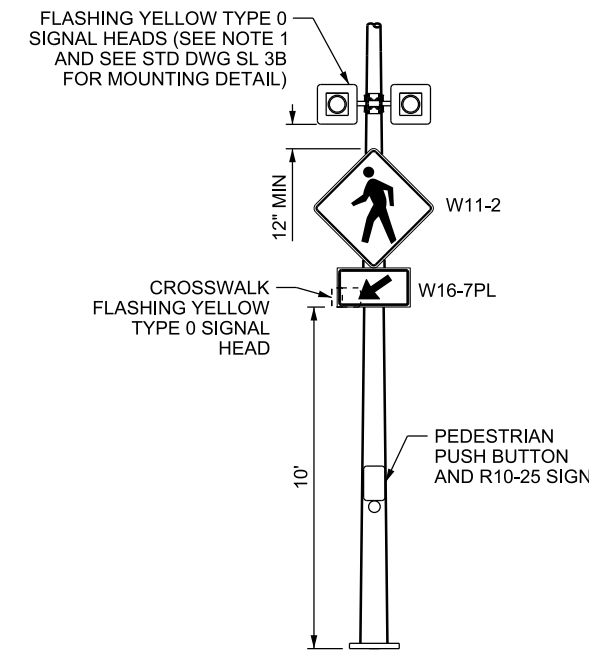

HIGH-MOUNT FLASHING BEACON DETAIL

LUMINAIRE POLE (SEE NOTE I AND STD DWG SL 5B)

LEGEND

- YELLOW TYPE 0 SIGNAL HEAD
- DETECTABLE WARNING SURFACE
- GROUND MOUNT SIGN
- FLASHING BEACON
- HIGH-MOUNT FLASHING BEACON

NOTES:

1. DO NOT PLACE RETROREFLECTIVE TAPE ON TYPE 0 SIGNAL HEAD BACKPLATES.
2. INCREASE MOUNTING HEIGHT OF W11-2 SIGN AND W16-7PL PLAQUE IF BLOCKED BY OTHER SIGNS OR OBSTRUCTIONS.

DESIGN-ONLY NOTES:

- A. INSTALL STREET LIGHTING UNLESS DIRECTED OTHERWISE BY REGION TRAFFIC OPERATIONS ENGINEER.
- B. USE LONGITUDINAL CROSSWALK MARKINGS WHEN REQUIRED BY REGION TRAFFIC OPERATIONS ENGINEER.
- C. PLACE YIELD LINE 4 FT FROM CROSSWALK ON SINGLE-LANE APPROACHES OR 50 FT FOR MULTI-LANE APPROACHES. USE "YIELD HERE TO PEDESTRIANS" R1-5 SIGN FOR MULTI-LANE APPROACHES.
- D. REFER TO UTAH MUTCD PART 7 FOR REQUIREMENTS AT SCHOOL CROSSINGS.
- E. DO NOT USE POST-MOUNTED FLASHING BEACON CROSSWALK WHEN POSTED SPEED EXCEEDS 35 MPH UNLESS OTHERWISE DIRECTED BY REGION TRAFFIC OPERATIONS ENGINEER.
- F. PLACE "NO PARKING" SIGNS TO PROHIBIT PARKING 50 FT BEFORE CROSSWALK AND 20 FT AFTER CROSSWALK FOR EACH APPROACH. NO ACCESSES ARE ALLOWED IN THIS AREA.
- G. A MULTI-LANE APPROACH HAS TWO OR MORE LANES MOVING TOWARD THE INTERSECTION, INCLUDING TURNING LANES.
- H. DO NOT INSTALL FLASHING BEACON CROSSWALK WITHIN A REDUCED SPEED SCHOOL ZONE.
- I. DO NOT INSTALL POST-MOUNTED FLASHING BEACONS WHERE THERE ARE THREE OR MORE THRU LANES IN ONE DIRECTION. EACH LANE, INCLUDING TURN LANES, MUST HAVE AN ADJACENT POST-MOUNTED FLASHING BEACON.
- J. RAISED MEDIAN DIMENSIONS DETERMINED BY LOCATION NEEDS. SEE GW SERIES STD DWGS. MEET LATERAL OFFSET REQUIREMENTS.

REVISIONS

NO.	DATE	APPR.	REMARKS
1	2/22/18	JS	REVISED CALLOUTS, NOTES AND GRAPHICS. DELETED RREF FROM STD DWGS. DELETED YIELD LINE DISTANCE TABLE.

UTAH DEPARTMENT OF TRANSPORTATION
STANDARD DRAWINGS FOR ROAD AND BRIDGE CONSTRUCTION
SALT LAKE CITY, UTAH

RECOMMENDED FOR APPROVAL
Randy J. ...
CHAIRMAN STANDARDS COMMITTEE

APPROVED
[Signature]
DEPUTY DIRECTOR

DATE: FEB. 22, 2018
DATE: FEB. 22, 2018

POST-MOUNTED FLASHING BEACON AT A MIDBLOCK CROSSWALK

STANDARD DRAWING TITLE

SUPPLEMENTAL DRAWING

STD. DWG. NO. SL 6G