

# **Route 222**

*Updated: November 2008*

Junction with Route 7 southeasterly to Wallsburg May 13,  
1941

**1953 Description:**

From Route 7 southeasterly to Wallsburg.

**Approved by the 1963 Legislature:**

**1965 Legislature:**

**1967 Legislature:**

**1969 Legislature:**

*Withdrawn* as State Route by the **1969 Legislature.**

\*(A) Commission Action May 27, 2004 Re-designate portion of SR-224 to new SR-222 in Wasatch County.

**2004 Legislature:**

From Route 113 in Midway northerly to Pine Creek Campground.

**2005 Legislature:** Description remains the same.

**2006 Legislature:** Description remains the same.

**2007 Legislature:** Description remains the same.

**2008 Legislature:** Description remains the same.

\*Refers to resolution index page following.

## **Route 222**

### **COUNTY/VOLUME & RESOLUTION NUMBER**

A. Wasatch Co. 11/6

### **DESCRIPTION OF RESOLUTION CHANGE**

(A). Re-designation-

Portion of SR 224 to new SR 222.  
From Route 113 in Midway  
northwesterly to the Pine Creek  
Campground.

11-6

New  
SR-222  
redesignate  
SR-254



STATE OF UTAH DEPARTMENT OF TRANSPORTATION  
4501 South 2700 West Salt Lake City, UT 84119-5998 (801) 965-4000

## Memorandum

DATE: March 25, 2004

TO: THOSE LISTED BELOW

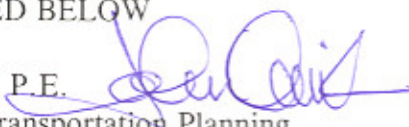
FROM: John L. Quick, P.E.   
Engineer for Transportation Planning

SUBJECT: Re-designate Portion of SR-224 to new SR-222 in Wasatch County

This proposed action was presented to the Transportation Commission on May 27, 2004 and it was discussed that this action could be a Department Administration action not requiring a resolution by the Commission.

The configuration of SR-224 creates confusion and misunderstanding to the general public and Region 3 Director and Program Development personnel, perceiving the related problems has agreed the renumbering the portion of SR-224 in Wasatch County will eliminate this problem.

The following action has been taken to eliminate the confusion on this broken route. SR-224 in the portion traversing northwesterly from the Junction of SR-113 in Midway to the Pine Creek Campground, a distance of  $3.335 \pm$  miles, will be assigned as SR-222. The function classification will be Major Collector from 0.000 to  $2.041 \pm$  miles and Minor Collector from  $2.041$  to  $3.335 \pm$  miles. SR-224 will begin at the Wasatch/Summit County line traversing through Ontario Canyon and Park City to Route 80 at Kimball Junction for a distance of  $11.610 \pm$  miles. The function classification will be Minor Collector from 0.000 to  $2.911 \pm$  miles; Major Collector from  $2.911$  to  $6.032 \pm$  miles; and Minor Arterial from  $6.032$  to  $11.610 \pm$  miles.

Map, exhibit A, showing the location of SR-222 is attached.

JLQ/mb  
Attachment

Memo - SR-224 & SR-222

Page Two

March 25, 2004

Max Ditlevsen, Program Development Director  
Lloyd Neeley, Pavement Management Engineer  
Gary Kuhl, Planning Statistical Engineer  
Lee Theobald, Information Analyst Supervisor  
Jerry Arnold, HPMS Coordinator  
Mark Fry, Transportation Data Planner  
Scott Nay, Transportation Data Planner  
Russ Scovil, Field Inventory Engineer  
Wayne Jager, Statewide Planning Engineer  
Kelli Bacon, Chief Cartographer  
Kim Schvaneveldt, Engineer for Programming  
Brett Hadley, Local Government Program Eng  
Chris Glazier, GIS Coordinator  
Bret Anderson, STIP Coordinator  
Brett Hadley, Local Gov. Programs Eng.  
Kathy Starks, Program Development Officer  
Char Mitchell, Programming Coordinator  
Leone Harwood, Transit Manager  
Linda Toy-Hull, Dir. Leg. & Government Affairs  
Chuck Larsen, Comptroller  
Darrell Giannonatti, Director for Const. &  
Materials  
Jason Davis, Engineering Services Director  
Brent Jensen, Chief Environ. Engineer  
Keith Brown, Chief Geotechnical Engineer  
David Kinnecom, ITS (TOC) Manager  
Richard Clarke, Engineer for Maintenance  
Lynn Bernhard, Methods Planning Engineer

Jim McMinimee, Project Development Director  
Stan Burns, Engineer for Research & Develop.  
Fran Rieck, Statewide Permits Officer  
Lyle McMillan, Right of Way Chief  
Warren Grames, Risk Manager  
Rae Ann Jensen, Records Supervisor  
David Nazare, Bridge Management Eng./Structures  
Robert Hull, Engineer for Traffic & Safety  
Robert Clayton, Accident Information Manager  
Zeke Gonzalez, Studies Engineer  
Peter Jager, Traffic Studies Engineer  
John Leonard, Traffic Operations Engineer  
Larry Montoya, Signal & Lighting Engineer  
Glenn Schulte, Transportation Safety Specialist  
Peter Tang, Safety Transportation System  
Major Neil Porter, Utah Highway Patrol  
Tracy Conti, Region Three Director  
Merrell Jolley, Region Three Preconstruction Eng.  
Alan Bills, North Area Supervisor - Region Three  
Val Davis, Shed 3431 Supervisor  
Barry Sawsak, Region Three Permits  
Grant Wiley, Region Three Pavement Manager  
Randy Park, Region Two Director  
Todd Richins, East Area Supervisor - Region Two  
Darrell Roberts, Shed 2435 Supervisor  
Alan Loiacono, Region Two Permits  
Steve Park, Region Two Pavement Manger

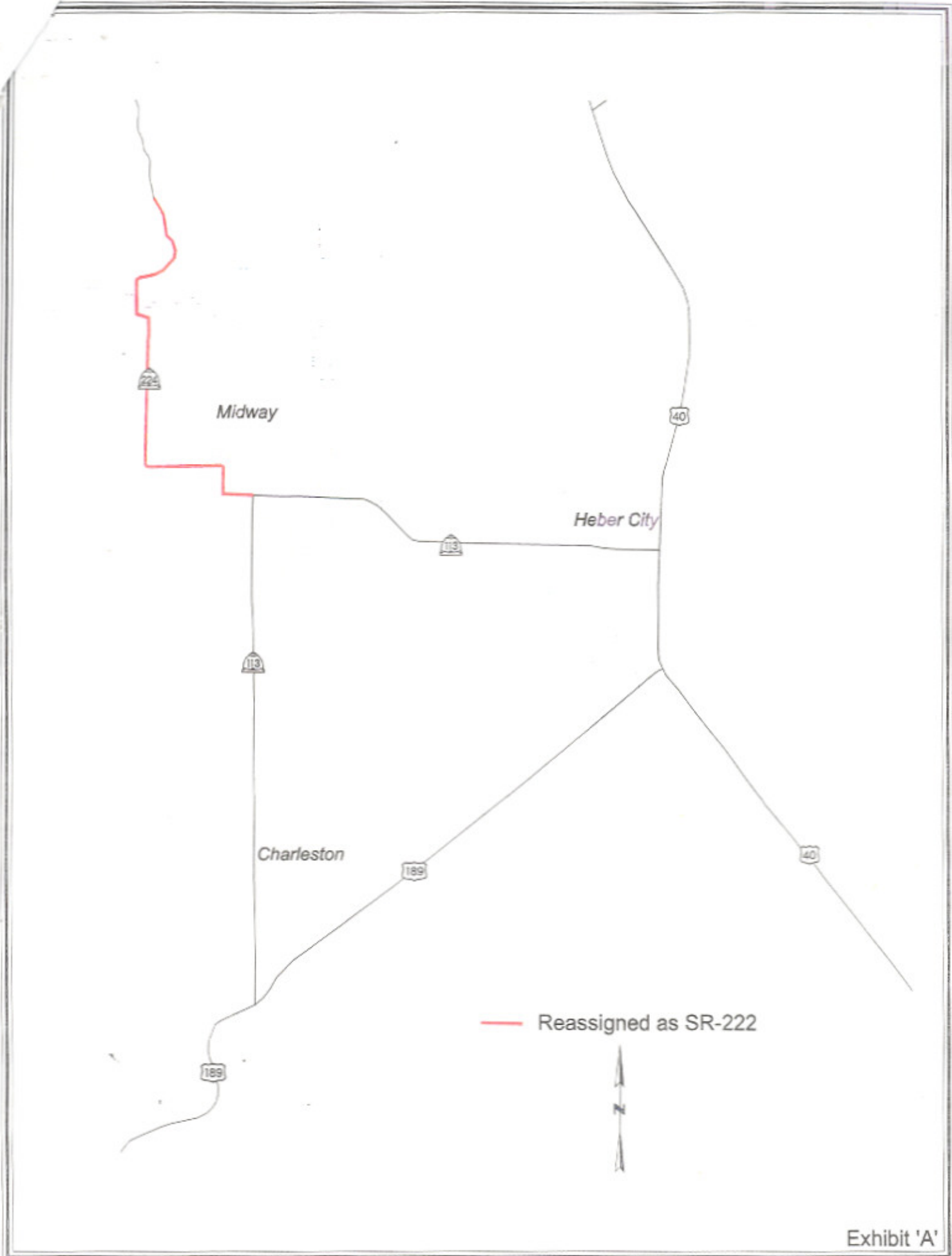

**From:** Merrell Jolley  
**To:** Marva Braun  
**Date:** 3/24/04 10:56AM  
**Subject:** Re: SR-224

It is fine with me.

>>> Marva Braun 3/23/2004 11:05:27 AM >>>

Tracy-

This email is in reference to our telephone conversation this morning. We have been looking at different routes throughout the state and SR-224 is one of those routes. SR-224 begins at SR-113 junction in Midway and continues north to just past the Pine Creek Campground area for 3.336 miles and stops. Then SR-224 resumes again at the Wasatch/Summit county line and continues to I-80 "Kimball Interchange". Our suggestion is to begin SR-224 at the Wasatch/Summit county line and end at I-80. Then take the portion that begins at SR-113, which runs for just over 3 miles, and renumber it SR-222. I look forward to hearing from you on this matter.

Marva

**From:** Tracy Conti  
**To:** Braun, Marva  
**Date:** 3/24/04 2:14PM  
**Subject:** Re: SR-224

Marva, In talking to our people and Midway City, we are fine with the change to SR-222. In fact in may help our maintenance crews in some ways. Thanks TC

>>> Marva Braun 03/23/04 11:05AM >>>

Tracy-

This email is in reference to our telephone conversation this morning. We have been looking at different routes throughout the state and SR-224 is one of those routes. SR-224 begins at SR-113 junction in Midway and continues north to just past the Pine Creek Campground area for 3.336 miles and stops. Then SR-224 resumes again at the Wasatch/Summit county line and continues to I-80 "Kimball Interchange". Our suggestion is to begin SR-224 at the Wasatch/Summit county line and end at I-80. Then take the portion that begins at SR-113, which runs for just over 3 miles, and renumber it SR-222. I look forward to hearing from you on this matter.

Marva

**CC:** Arnold, Jerry; Kuhl, Gary; Quick, John