

09-JUL-2018 DGN File: D:\StandardSpecs\Section\207\Section\All Supp Issues\Issue 5 06-28-2018\Drawings\TC09.dgn

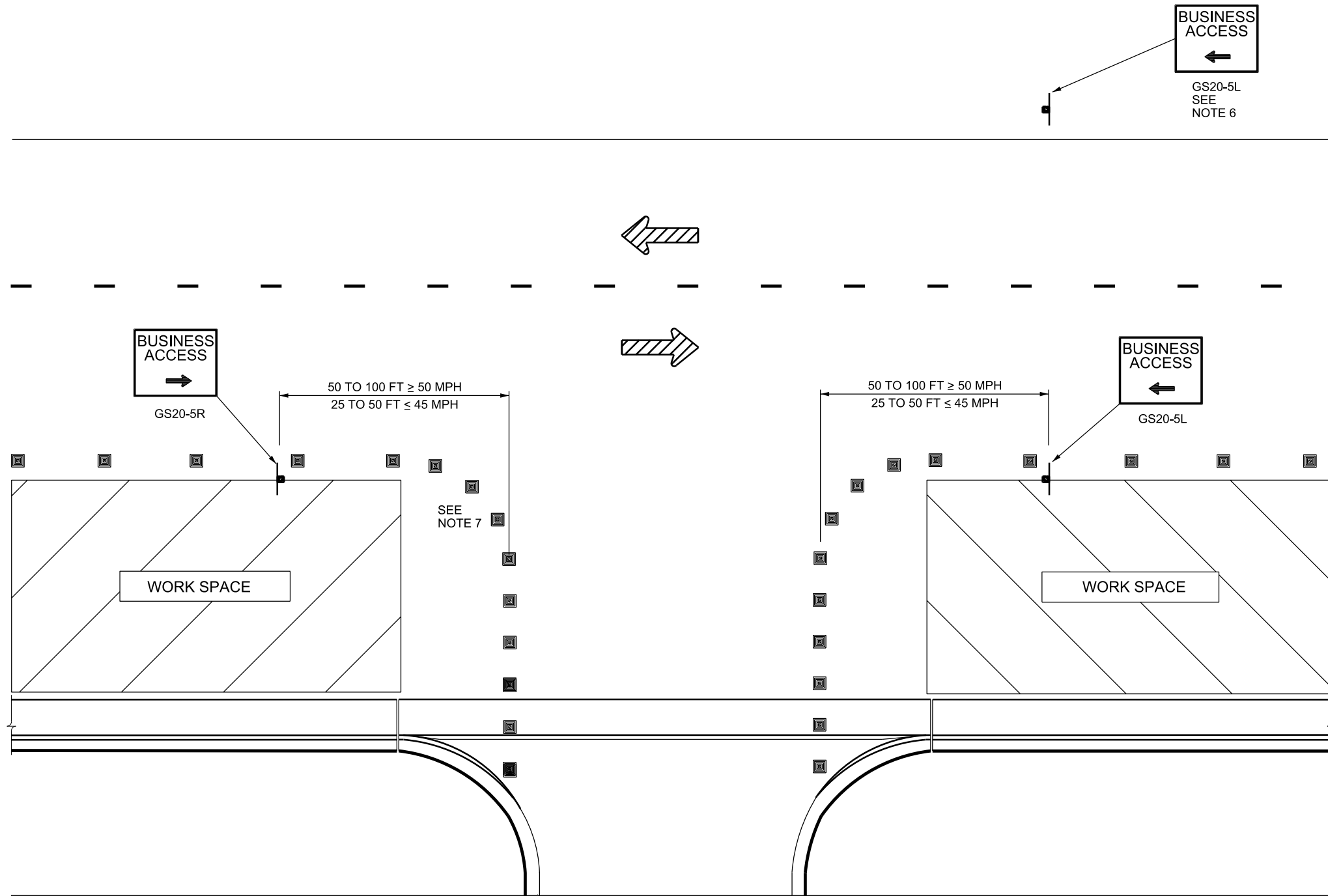

**TYPICAL BUSINESS ACCESS PLAN**

EXAMPLE ONLY - NOT TO SCALE  
 SETUP TO BE SITE SPECIFIC

**NOTES:**

1. USE TO DEFINE BUSINESS ACCESS WITHIN WORK ZONES.
2. USE 5 FT MINIMUM MOUNTING HEIGHT.
3. USE JOINT ACCESS WHERE PRACTICAL.
4. CONSIDER USING DIFFERENT CHANNELIZING DEVICES TO HIGHLIGHT ACCESS (USE VERTICAL PANELS ALONG ROADWAY AND BARRELS WITHIN ACCESS LIMITS, FOR EXAMPLE).
5. REFER TO STD DWG TC 4A FOR TRAFFIC CONTROL DEVICE LEGEND.
6. CONSIDER USE OF RIGHT SIDE GS20-5 SIGN WHEN REQUIRED BUSINESS ACCESS SIGN IS OBSCURED BY WORK ZONE ACTIVITIES OR OPPOSING TRAFFIC.
7. USE 10 FT MAXIMUM SPACING BETWEEN DEVICES IN DRIVEWAY.
8. REFER TO TC 4D SERIES STD DWGS FOR DESIGN OF GS20-5 BUSINESS ACCESS SIGN.
9. DO NOT PLACE BUSINESS NAME, LOGO OR OTHER ADVERTISEMENT ON OR UNDER GS20-5 SIGNS. SEE STD DWG TC 1 NOTE 25.

**SUPPLEMENTAL DRAWING**

REVISIONS		NO.	DATE	APPR.	REMARKS
1	6/28/18	RT	UPDATED NOTE 9.		

**UTAH DEPARTMENT OF TRANSPORTATION**  
 STANDARD DRAWINGS FOR ROAD AND BRIDGE CONSTRUCTION  
 SALT LAKE CITY, UTAH

RECOMMENDED FOR APPROVAL  
*Randy P. Clark*  
 CHAIRMAN STANDARDS COMMITTEE  
 APPROVED

DEPUTY DIRECTOR

DATE: JUNE 28, 2018

**WORK ZONE BUSINESS ACCESS SIGNING**

STANDARD DRAWING TITLE

STD. DWG. NO. **TC 9**