

CONCRETE BARRIER INSTALLATION DETAIL

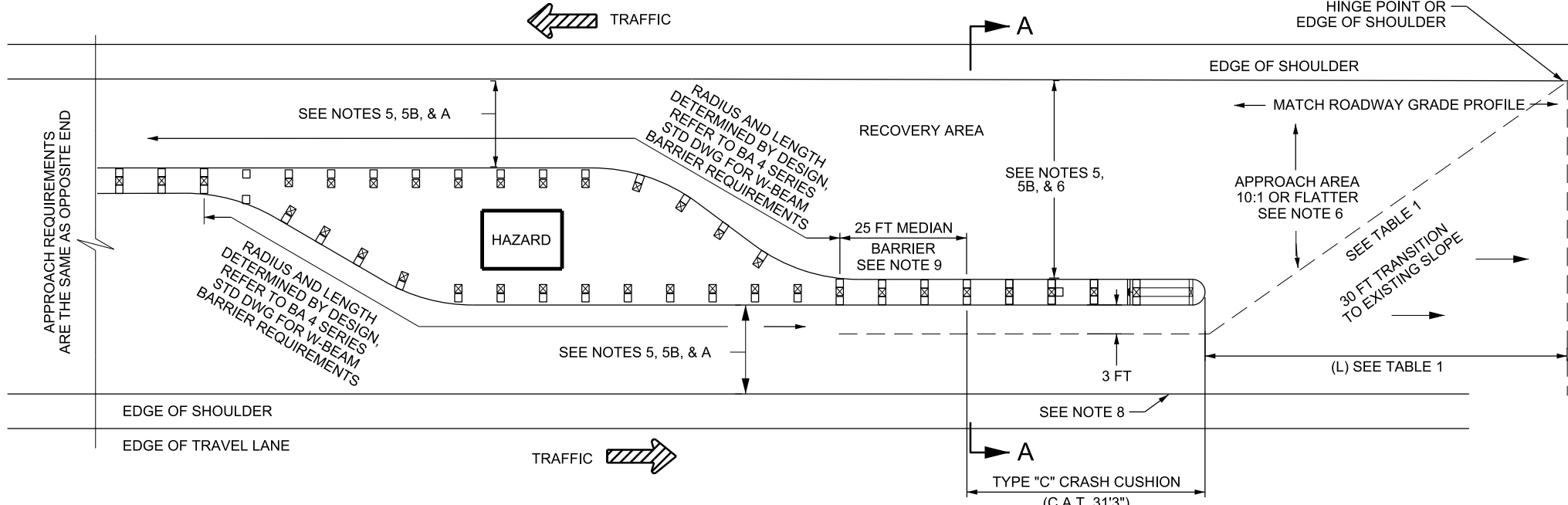
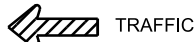

W-BEAM GUARDRAIL BARRIER INSTALLATION DETAIL

TABLE 1

SPEED MPH	MIN LENGTH (L)
LESS THAN 40	50 FT
40 TO 55	70 FT
60 TO 80	100 FT

- DESIGN-ONLY NOTES:**
- A. 2 FT MINIMUM BARRIER OFFSET IS OPTIONAL WHEN ROADWAY DESIGN REQUIRES A 12 FT OR WIDER EFFECTIVE SHOULDER.
- NOTES**
1. THE C.A.T., MANUFACTURED BY TRINITY INDUSTRIES. SEE GUIDELINES FOR CRASH CUSHIONS AND BARRIER END TREATMENTS FOR SPECIFIC SYSTEM DETAILS.
 2. INSTALL SYSTEM ACCORDING TO MANUFACTURER'S SPECIFICATIONS.
 3. HAVE SHOP DRAWING AVAILABLE ON SITE FOR REFERENCE DURING INSTALLATION.
 4. USE GRADED AND COMPACTED SURFACE FOR C.A.T. SYSTEMS.
 5. COMPLETE SLOPE PREPARATION PRIOR TO INSTALLING SYSTEM. MEET SLOPE REQUIREMENTS IN RECOVERY AREA AS DETAILED IN APPLICABLE UDOT ROADWAY DESIGN MANUAL DRAWINGS. THE ADDITIONAL INFORMATION LISTED BELOW IS THE MINIMUM ACCEPTABLE SLOPE REQUIREMENTS APPROACH AND RECOVERY AREAS OF THIS CRASH CUSHION SYSTEM.
 - A. USE A 10:1 OR FLATTER FORESLOPE IN THE APPROACH AND RECOVER AREAS WHEN SYSTEM IS BEING USED IN CONJUNCTION WITH CONCRETE BARRIER.
 - B. USE A 10:1 OR FLATTER FORESLOPE IN THE APPROACH AND RECOVER AREA WHEN SYSTEM IS BEING USED IN CONJUNCTION WITH W-BEAM GUARDRAIL.
 6. CLEAR RECOVERY AND APPROACH AREAS OF ANY FIXED OBJECTS. DO NOT PLACE SIGNS OR POLES IN APPROACH AREA. SIGNS OR POLES PLACED IN THE RECOVERY AREA WILL BE BREAKAWAY AND BE A MINIMUM 10 FT FROM SYSTEM RAIL ELEMENTS.
 7. INSTALL REQUIRED MARKINGS AS PER STD DWG CC 1.
 8. REFER TO BA 4 SERIES STD DWGS FOR MEDIAN BARRIER TRANSITION.
 9. ADJUST W-BEAM MEDIAN BARRIER OR W-BEAM MEDIAN BARRIER TRANSITION HEIGHT FROM 31 INCHES TO 28 INCHES OVER LENGTH OF 25 FT FOR ATTACHMENT TO THE C.A.T. SYSTEM.

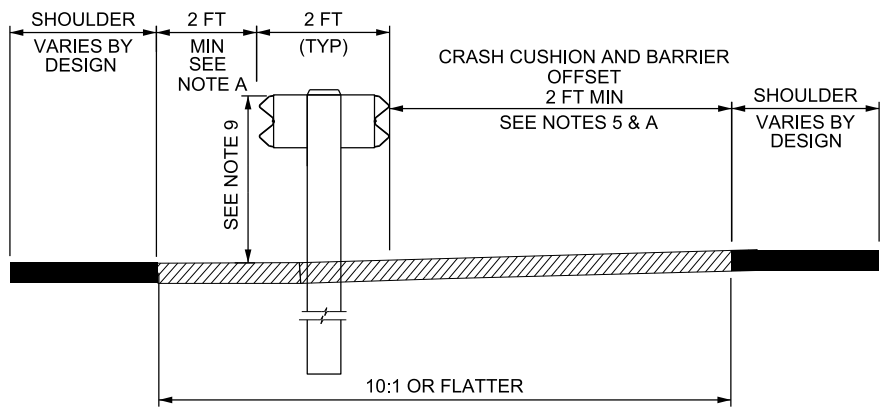

SECTION A-A

MEDIAN APPLICATION
USE WHEN SLOPES ARE 10:1 OR FLATTER ACROSS MEDIAN WIDTH

REVISIONS

NO.	DATE	APPR.	REMARKS

UTAH DEPARTMENT OF TRANSPORTATION

STANDARD DRAWINGS FOR ROAD AND BRIDGE CONSTRUCTION

SALT LAKE COUNTY, UTAH

RECOMMENDED FOR APPROVAL

APPROVED

DEPUTY DIRECTOR

DATE: AUG 30, 2018

GRADING AND PLACEMENT DETAILS

CRASH CUSHION TYPE C

C.A.T.

STANDARD DRAWING TITLE

STD. DWG. NO. CC 5A

SUPPLEMENTAL DRAWING

12-SEP-2018 DGN File: D:\Standard\Spec\Section\207\Section\111_Supp_Issues\Issue 6 08-30-2018\Drawings\CC05A.dgn