

12-SEP-2018 DGN File: D:\StandardSpec\Section\2017\Section\11_Supp_Issues\Issue 6 08-38-2018\Drawings\1107.dgn

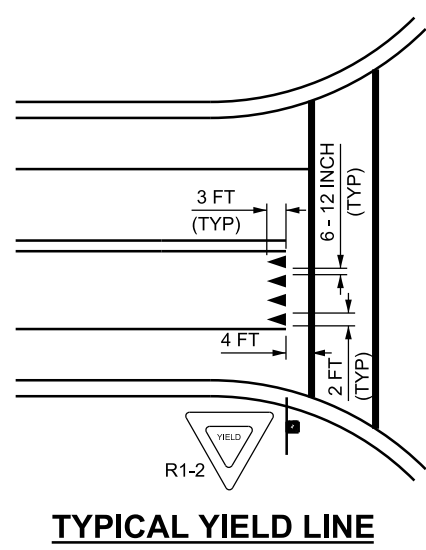

TYPICAL YIELD LINE

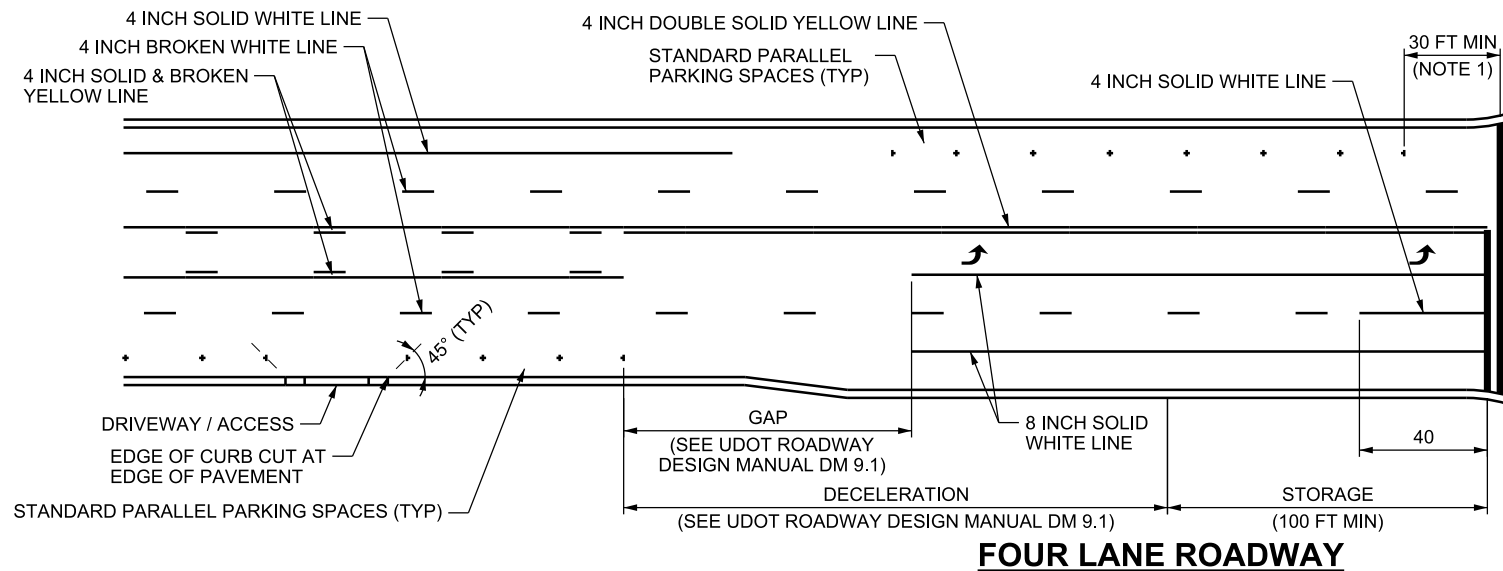

FOUR LANE ROADWAY

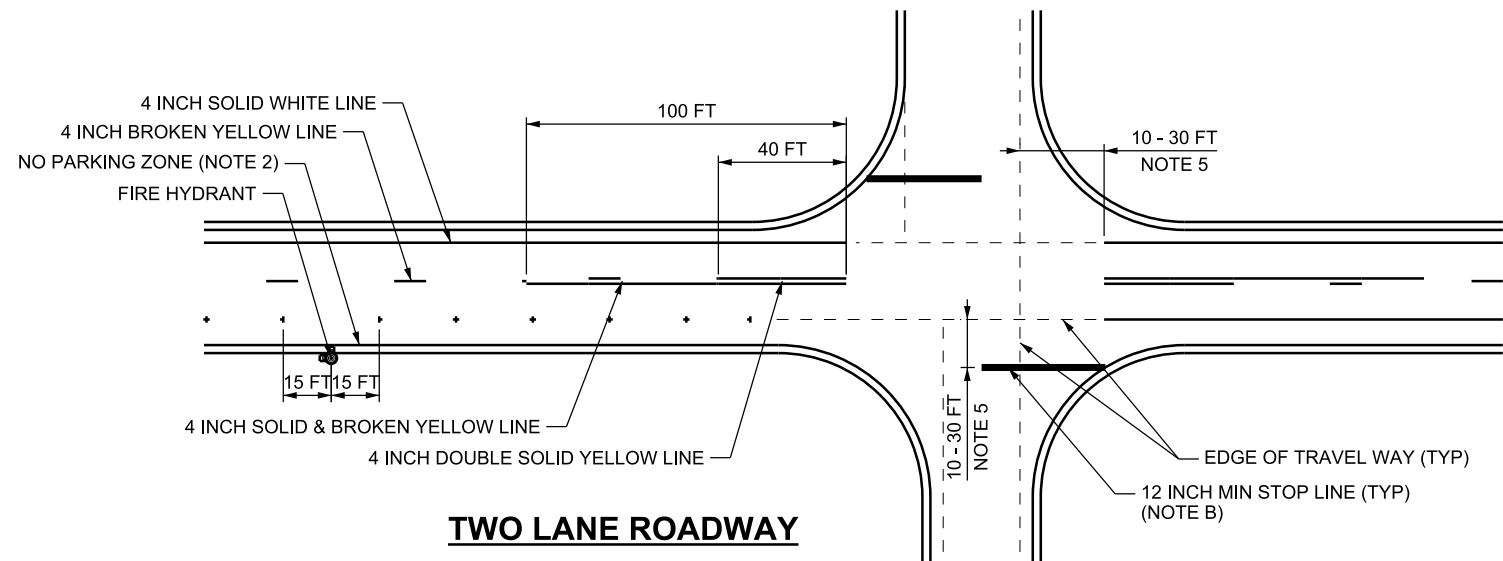
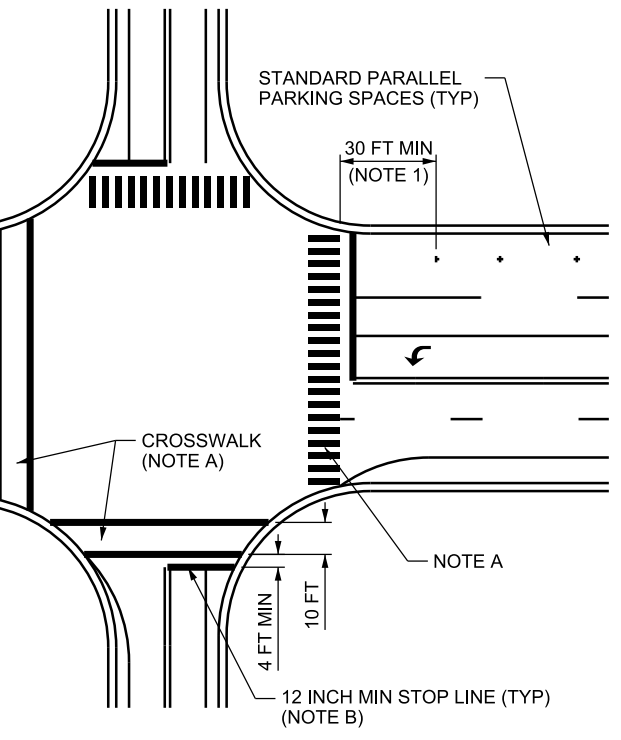

TWO LANE ROADWAY

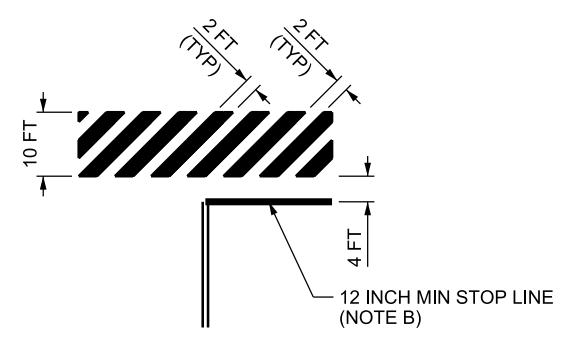

SPECIAL EMPHASIS CROSSWALK

SOLID WHITE DIAGONAL LINES AT 45° TO DIRECTION OF TRAVEL (NOTE A)

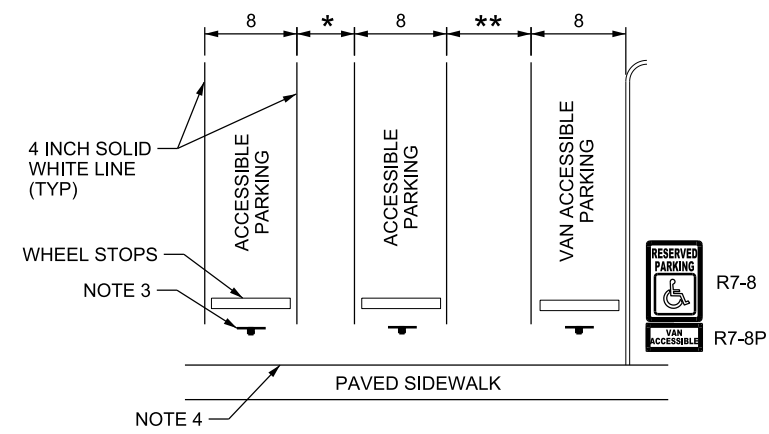

PARKING LOT STRIPING FOR RESERVED ACCESSIBLE PARKING

* 5 FT MIN FOR ACCESSIBLE PARKING
 ** 8 FT MIN FOR VAN ACCESSIBLE PARKING.
 PROVIDE ONE VAN ACCESSIBLE STALL FOR EVERY EIGHT ACCESSIBLE STALLS.

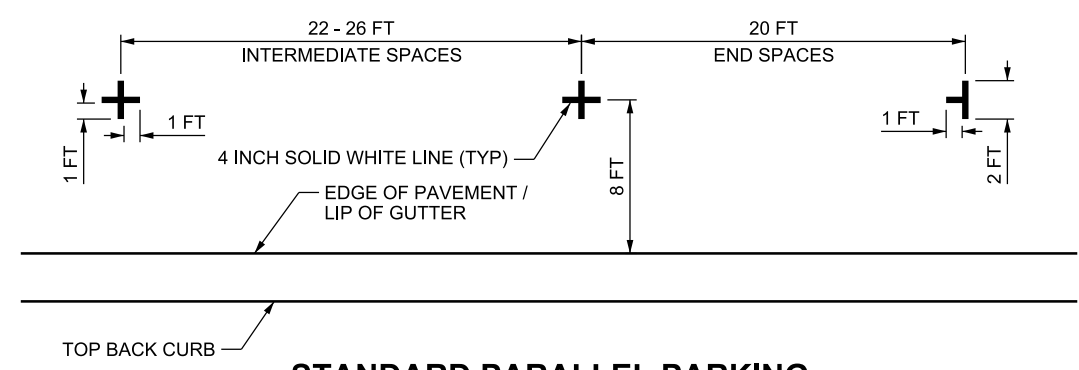

STANDARD PARALLEL PARKING

DESIGN-ONLY NOTES:

- A. THE REGION TRAFFIC ENGINEER DETERMINES THE LOCATION AND TYPE OF CROSSWALKS AT AN INTERSECTION.
- B. USE A 24 INCH STOP LINE WHERE:
 - A SCHOOL CROSSWALK IS PLACED
 - AT SIGNALIZED INTERSECTION WHERE NO CROSSWALK IS PRESENT
 - AT THE DISCRETION OF THE REGION TRAFFIC ENGINEER

NOTES:

1. ESTABLISH A "NO PARKING" ZONE 30 FT PRIOR TO FLASHING SIGNAL, STOP SIGN, YIELD SIGN, OR SIGNAL.
2. RED CURB MARKING IS OPTIONAL FOR "NO PARKING" ZONE.
3. PROVIDE RESERVED PARKING SIGNING (R7-8) FOR ACCESSIBLE PARKING SPACES. INCLUDE VAN ACCESSIBLE PLAQUE (R7-8P) FOR VAN PARKING SPACES.
4. BLEND ACCESS AISLE WITH PAVED SIDEWALK OR PEDESTRIAN RAMP FOR SMOOTH ELEVATION TRANSITION.
5. PLACE STOP LINE 10-30 FT AWAY FROM THE EDGE OF TRAVEL WAY OF THE CROSS TRAFFIC TO ACCOMMODATE TURNING VEHICLES AND PROVIDE PROPER INTERSECTION SIGHT DISTANCE.

SUPPLEMENTAL DRAWING

NO.	DATE	APPR.	REMARKS

UTAH DEPARTMENT OF TRANSPORTATION
 STANDARD DRAWINGS FOR ROAD AND BRIDGE CONSTRUCTION
 SALT LAKE CITY, UTAH

RECOMMENDED FOR APPROVAL
Randy J. Park
 CHAIRMAN STANDARD SPEC COMMITTEE
 APPROVED

AUG 30, 2018
 DATE

AUG 30, 2018
 DATE

DEPUTY DIRECTOR

CROSSWALKS, PARKING, AND INTERSECTION APPROACHES

STANDARD DRAWING TITLE

STD. DWG. NO. **ST 7**