

04-SEP-2019 D:\F:\L\Standard\Drawings\Imperial\2017 Approved\Supplemental\Issues\Suppl0 Approved August - 2019\Backup\SL06G.DGN

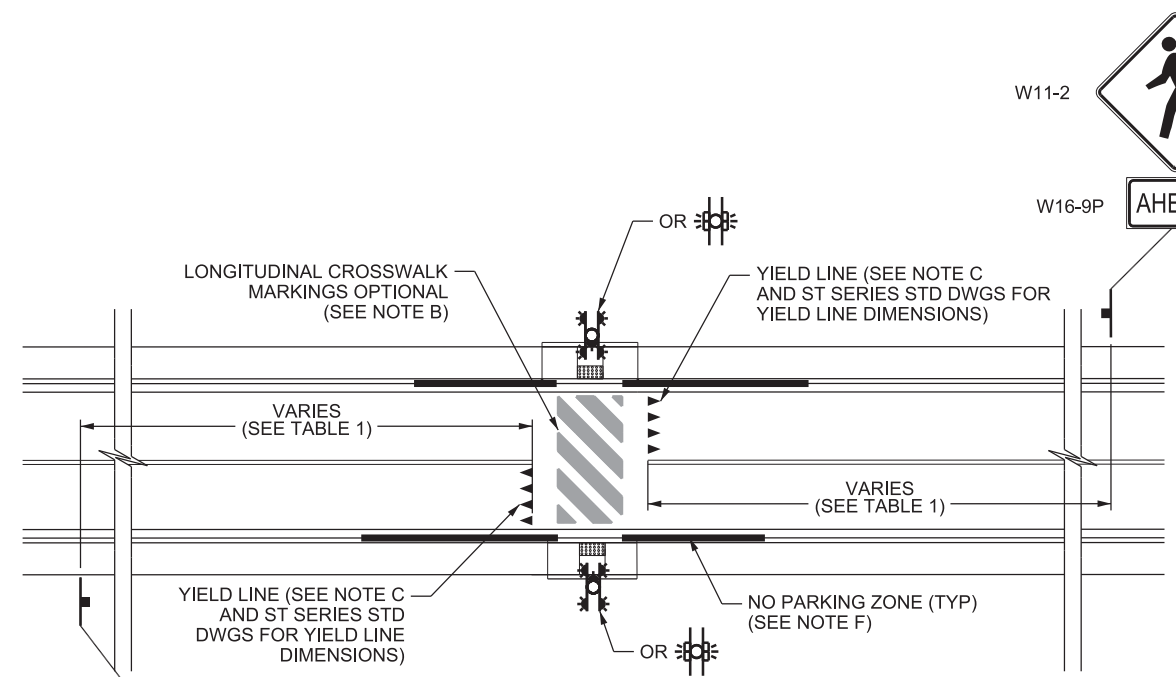

**SINGLE-LANE DETAIL**

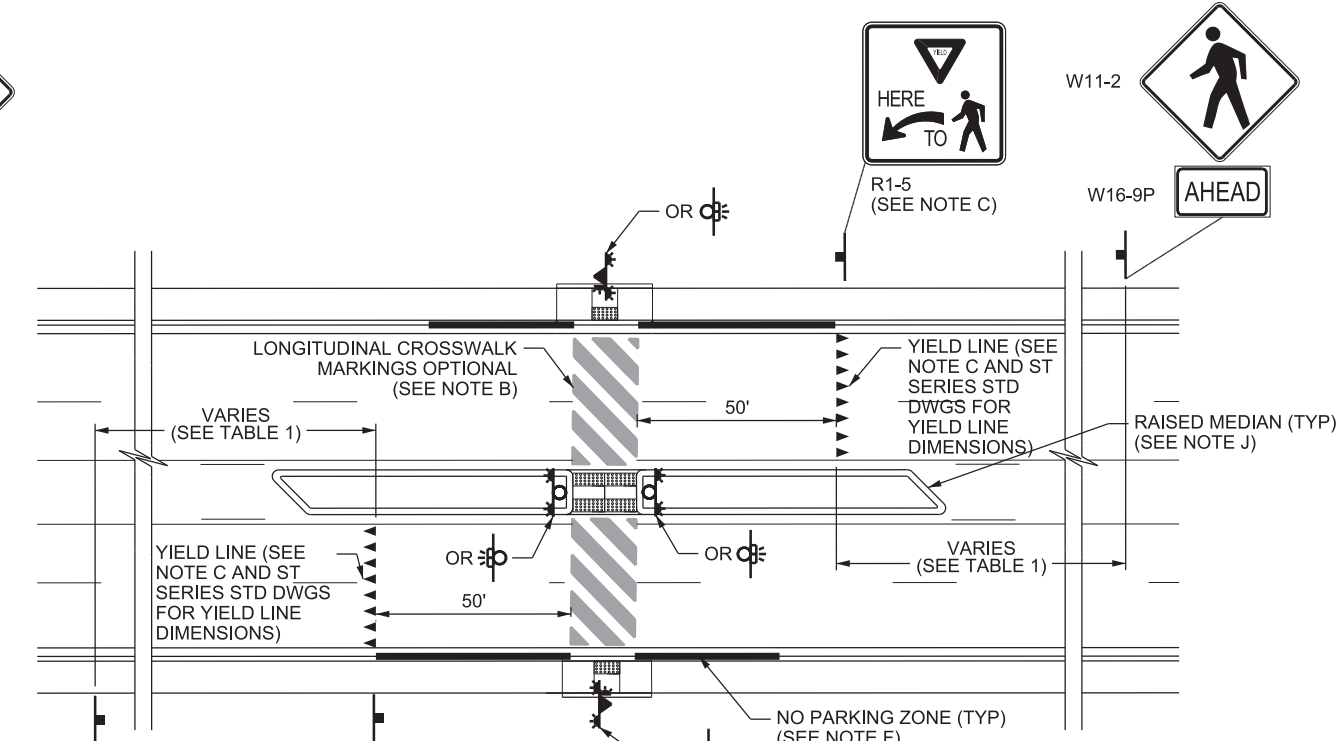

**MULTI-LANE DETAIL**

**TABLE 1**  
GUIDELINES FOR ADVANCE PLACEMENT OF PEDESTRIAN CROSSING WARNING SIGNS  
(SEE UTAH MUTCD TABLE 2C-4 FOR COMPLETE TABLE)

POSTED SPEED	ADVANCE PLACEMENT DISTANCE
20-35 MPH	100 FT
40 MPH (SEE NOTE E)	125 FT

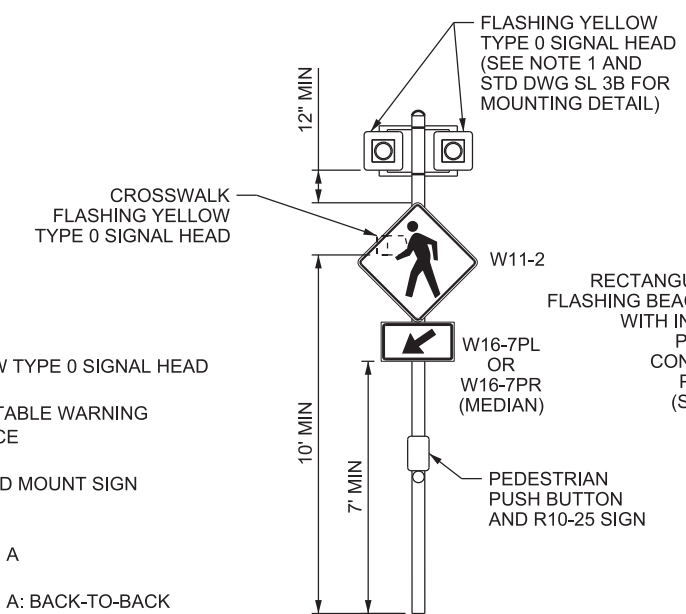
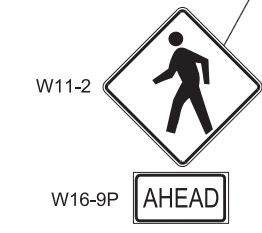
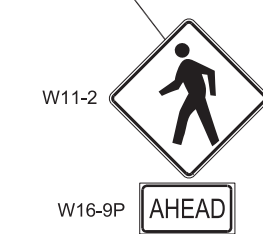

**OPTION A  
FLASHING BEACON DETAIL**

15 FT TRAFFIC SIGNAL POLE / LUMINAIRE POLE (SEE NOTES A, I AND STD DWG SL 1E)

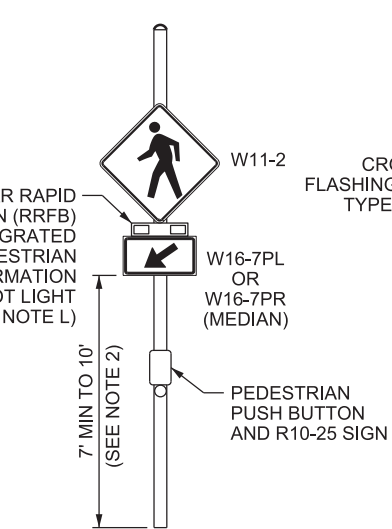

**OPTION B  
RRFB DETAIL**

15 FT TRAFFIC SIGNAL POLE / LUMINAIRE POLE (SEE NOTES A, I, AND STD DWG SL 1E)

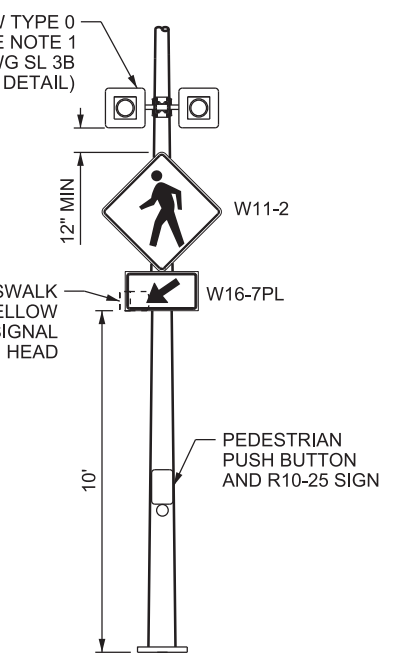

**OPTION C  
HIGH-MOUNT  
FLASHING BEACON DETAIL**

LUMINAIRE POLE (SEE NOTES A, I AND STD DWG SL 5B)

**LEGEND**

- YELLOW TYPE 0 SIGNAL HEAD
- DETECTABLE WARNING SURFACE
- GROUND MOUNT SIGN
- OPTION A
- OPTION A: BACK-TO-BACK (SEE NOTE K)
- OPTION B
- OPTION B: BACK-TO-BACK (SEE NOTE K)
- OPTION C

**NOTES:**

1. DO NOT PLACE RETROREFLECTIVE TAPE ON TYPE 0 SIGNAL HEAD BACKPLATES.
2. INCREASE MOUNTING HEIGHT OF W11-2 SIGN AND W16-7PL PLAQUE IF BLOCKED BY OTHER SIGNS OR OBSTRUCTIONS. USE A 10-FT TO BOTTOM OF SIGN MOUNTING HEIGHT FOR OPTION B ON OUTSIDE SHOULDER IN MULTI-LANE SITUATIONS TO PREVENT VISUAL BLOCKING FROM R1-5 SIGN.

**DESIGN-ONLY NOTES:**

- A. INSTALL STREET LIGHTING UNLESS DIRECTED OTHERWISE BY REGION TRAFFIC OPERATIONS ENGINEER.
- B. USE LONGITUDINAL CROSSWALK MARKINGS WHEN REQUIRED BY REGION TRAFFIC OPERATIONS ENGINEER.
- C. PLACE YIELD LINE 4 FT FROM CROSSWALK ON SINGLE-LANE APPROACHES OR 50 FT FOR MULTI-LANE APPROACHES. USE "YIELD HERE TO PEDESTRIANS" R1-5 SIGN FOR MULTI-LANE APPROACHES.
- D. REFER TO UTAH MUTCD PART 7 FOR REQUIREMENTS AT SCHOOL CROSSINGS.
- E. DO NOT USE POST-MOUNTED FLASHING BEACON CROSSWALK WHEN POSTED SPEED EXCEEDS 35 MPH UNLESS OTHERWISE DIRECTED BY REGION TRAFFIC OPERATIONS ENGINEER.
- F. PLACE "NO PARKING" SIGNS TO PROHIBIT PARKING 50 FT BEFORE CROSSWALK AND 20 FT AFTER CROSSWALK FOR EACH APPROACH. NO ACCESSES ARE ALLOWED IN THIS AREA.
- G. A MULTI-LANE APPROACH HAS TWO OR MORE LANES MOVING TOWARD THE INTERSECTION, INCLUDING TURNING LANES.
- H. DO NOT INSTALL FLASHING BEACON CROSSWALK WITHIN A REDUCED SPEED SCHOOL ZONE.
- I. DO NOT INSTALL POST-MOUNTED FLASHING BEACONS WHERE THERE ARE FOUR OR MORE LANES, INCLUDING TURNING LANES, IN ONE DIRECTION.
- J. RAISED MEDIAN DIMENSIONS DETERMINED BY LOCATION NEEDS. SEE GW SERIES STD DWGS. MEET LATERAL OFFSET REQUIREMENTS.
- K. BACK-TO-BACK CONSISTS OF W11-2 AND W16-7P SIGNS AND FLASHING BEACONS FACING OPPOSITE DIRECTIONS MOUNTED ON THE SAME POLE.
- L. MEET FHWA INTERIM APPROVAL (IA-21) REQUIREMENTS FOR RECTANGULAR RAPID FLASHING BEACON.
- M. RECTANGULAR RAPID FLASHING BEACONS CAN ONLY BE USED ON NON-CONTROLLED APPROACHES.
- N. DO NOT MIX POST-MOUNTED BEACON TYPES AT A CROSSWALK.

**UTAH DEPARTMENT OF TRANSPORTATION**  
STANDARD DRAWINGS FOR ROAD AND BRIDGE CONSTRUCTION  
SALT LAKE CITY, UTAH

**POST-MOUNTED FLASHING BEACON AT A MIDBLOCK CROSSWALK**

NO.	DATE	APPR.	REMARKS
1	2/22/18	JS	REVISED CALLOUTS, NOTES AND GRAPHICS. DELETED RRFB FROM STD DWGS. DELETED YIELD LINE DISTANCE TABLE.
2	8/30/18	JS	ADDED RRFB OPTION. CHANGED SINGLE LANE DETAIL TO HAVE OPTION A BACK-TO-BACK.
3	8/29/19	MRB	UPDATED REFERENCES FOR THE ST SERIES STANDARD DRAWINGS

RECOMMENDED FOR APPROVAL  
CHAIRMAN STANDARDS COMMITTEE  
APPROVED  
DEPUTY DIRECTOR

DATE: AUG. 29, 2019  
DATE: AUG. 29, 2019

STANDARD DRAWING TITLE  
**SL 6G**

**SUPPLEMENTAL DRAWING**

STD. DWG. NO.