

04-SEP-2019 D:\DCN\_Files\Standard Drawings\Imperial\2017 Approved\Supplemental\Issues\SupplB Approved August - 2019\Backup\BA03P2.dgn

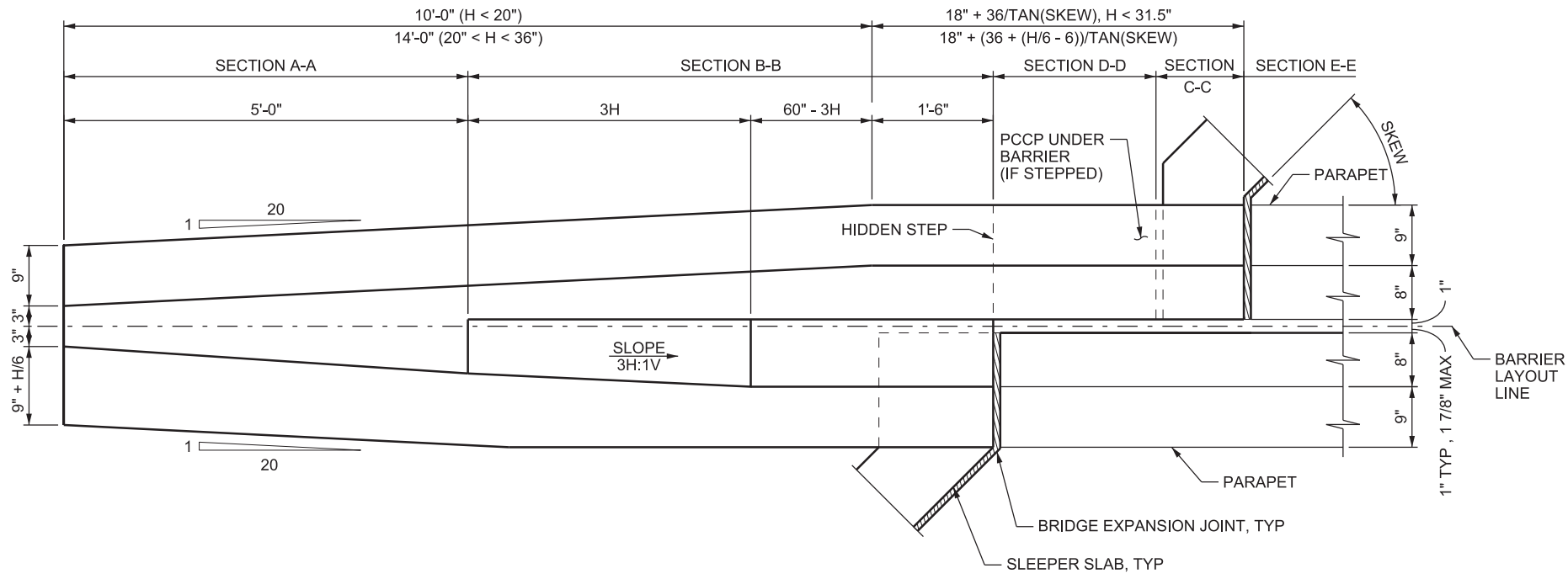

**PLAN - H < 36 INCH, 30° < SKEW < 45°**

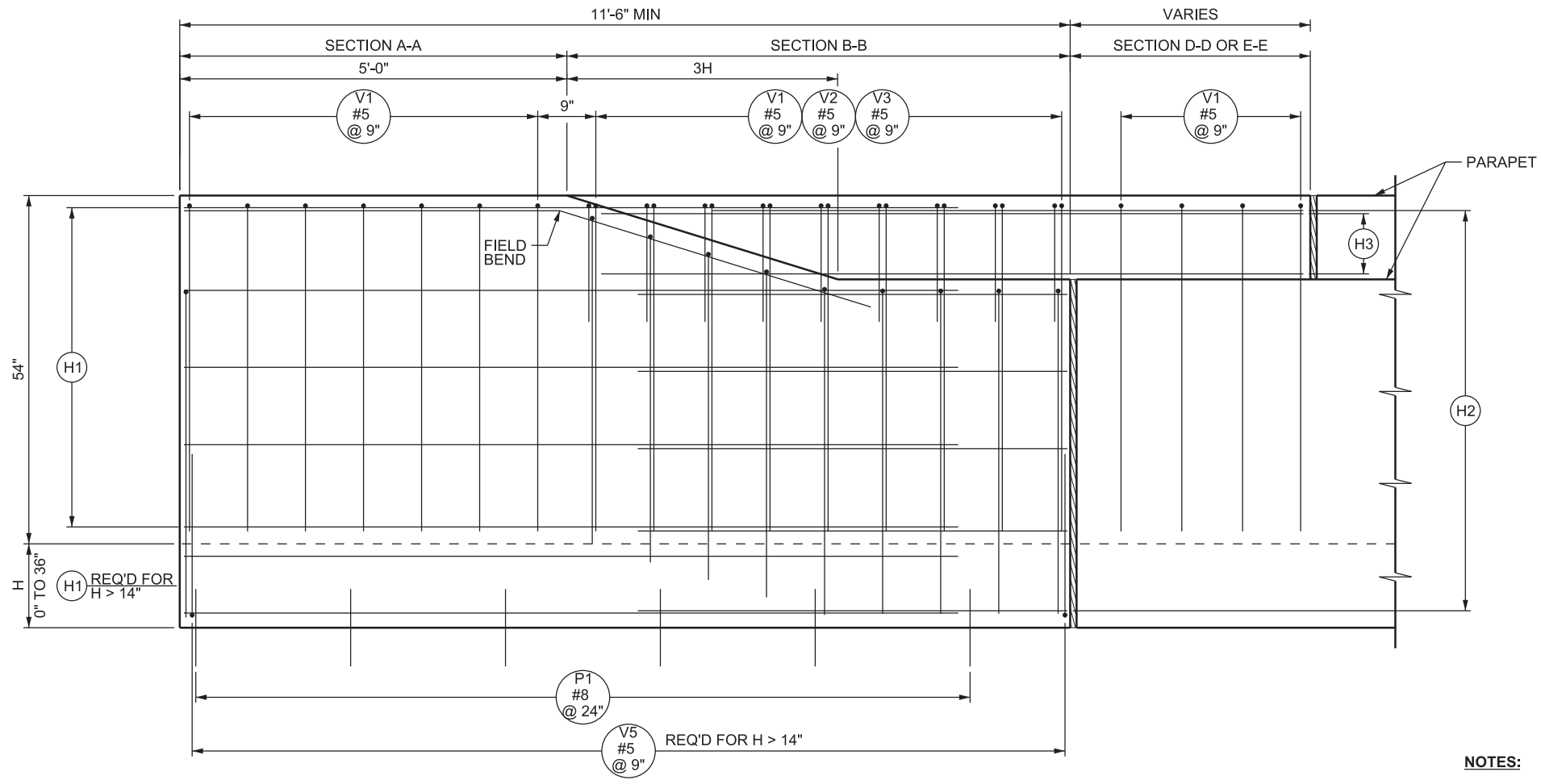

**ELEVATION - H < 36 INCH, 30° < SKEW < 45°**

**NOTES:**

- 1. SEE STD DWG BA 1A1 FOR GENERAL NOTES.
- 2. SEE STD DWG BA 3P3 FOR SECTIONS AND REINFORCING STEEL SCHEDULE.

**SUPPLEMENTAL DRAWING**

REVISIONS		SDD	NO.	DATE	APPR.	REMARKS
1	08/29/19					MODIFIED DESIGN ONLY NOTES TO NOTES.

**UTAH DEPARTMENT OF TRANSPORTATION**  
STANDARD DRAWINGS FOR ROAD AND BRIDGE CONSTRUCTION  
SALT LAKE CITY, UTAH

RECOMMENDED FOR APPROVAL  
CHAIRMAN STANDARDS COMMITTEE  
APPROVED

DATE: AUG. 29, 2019  
DATE: AUG. 29, 2019  
DEPUTY DIRECTOR

**CAST-IN-PLACE CONCRETE  
CONSTANT SLOPE BARRIER  
- 54 INCH, BRIDGE  
PARAPET TRANSITION  
2 OF 3**

STANDARD DRAWING TITLE

STD. DWG. NO.  
**BA 3P2**