

UDOT plans to improve the interchange located at I-15 and 9000 South in Sandy City

UDOT plans to improve the interchange located at I-15 and 9000 South by adding additional lanes to the ramps and widening 9000 South, east of I-15 to Monroe Street. Construction is expected to begin in June and is expected to continue through October 2017*.

STAY INFORMED

Sign up for project emails to stay up-to-date on construction progress and impacts at southvalley@utah.gov with “**9000 South Interchange**” in the subject line.

*Construction schedules are subject to change due to utility, material, weather or equipment delays.

South Valley IMPROVEMENTS I-15; 9000 South Interchange

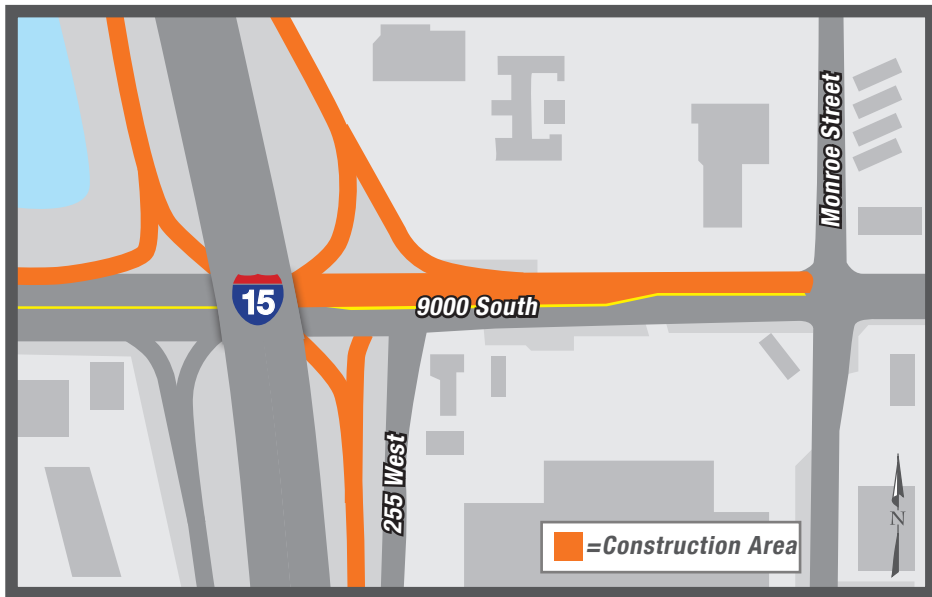

A UDOT PROJECT

HOTLINE: 801-228-0022, option 4

WEBSITE: udot.utah.gov/southvalleyimprovements

UDOT
Keeping Utah Moving



I-15; 9000 South Interchange

UDOT plans to improve the interchange located at I-15 and 9000 South by adding additional lanes to the ramps and widening 9000 South, east of I-15 to Monroe Street.

IMPROVEMENTS INCLUDE:

- Lane additions to the on and off ramps
- Signal modifications
- Alleviated traffic congestion
- Improved accessibility on and off I-15

STAY INFORMED

EMAIL: southvalley@utah.gov

HOTLINE: 801-228-0022, option 4

WEBSITE: udot.utah.gov/southvalleyimprovements

South Valley
IMPROVEMENTS
I-15; 9000 South Interchange